

The Leanyer Patch

1st and 2nd May 2021

Welcome to our Leanyer patch, we hope you have an enjoyable visit and maybe find some inspiring ideas for your own garden.

We moved into this property in July 2013 and the contrast to what it is today could not be starker. Originally it took 3.5hrs on a ride on mower to mow all the grass and there were acres and acres of coffee bush (*Leucaena leucocephala*) which was so thick in parts it was easy to question if you had walked onto a neighbouring property. Hundreds of loads of coffee bush went to the tip along with constant spraying of seedlings as coffee bush seeds can last over 10 years in the soil. Over the last 7+ years we have created most of what you see here today. We are still making new beds and planting out new sections each wet season. We have endeavoured to keep the top third of the block tropical around the house and the remaining two thirds predominantly native.

One of the biggest speed factors for the re-development of this garden was meeting with Emma Lupin at a Greening Australia nursery sale, she introduced us to the Land for Wildlife program which really propelled our interest and participation in the wider gardening community. Through this program we have participated in workshops and projects which have grown (pun intended) our understanding and use of native plants. Through this introduction we also were able to take part in a federal government initiative to plant trees on the property to support habitat for the black footed tree rat (a threatened species of the NT) and in December 2017 the Green Army planted approx. 500 native trees. Additionally, we are members of the Darwin City Councils Gardens for Wildlife program and have previously hosted tours and education sessions.

The introduction of natives and the many ponds and water features around the house has attracted loads of wildlife to the garden including:

- Insects - there are two native beehives in the poles around the house veranda and the cicadas become deafening when they get going.
- Birds - we have 3 resident pairs of bush stone curlews that nest on the block and numerous pairs of orange footed scrub fowl who insist on rebuilding the mound we previously levelled. There are now 3 mounds on the go. See if you can spot them on the property as you walk around.
- Reptiles - including snakes mostly pythons usually trying to eat our chooks or their eggs, frogs, and lizards (we even saw a frilled neck lizard one time) ☺

The charity we are supporting this weekend is Prism, an LGBTQI group for young people aged 12 to 25 years run by Headspace Darwin. It is a confidential place for LGBTQI youth to be themselves, feel safe, connect with other likeminded young people, and find out information about health, services, and support. This group is open to any young person aged 12 -25 years in the community. They are selling food and drinks throughout the weekend, so we encourage you to grab a bite and find a shady spot and enjoy the surroundings.

There will be plants for sale across the weekend, Tim Moore and the Territory Native Plants team will be selling some Territory native plants will run some tours around the garden at scheduled intervals to show what their stock can grow into once matured.

We would like to take this opportunity to thank the following people whose support has made this weekend and garden possible – in no order, thank you Emma Lupin, Land for Wildlife Top End, Green Army, Greening Australia, Tim Moore, Jody from the Open Garden committee, Triston from Darwin City Council and Richard for his donation of Native Plants.

We are on the lookout for any old pavers, bricks and Besser blocks that we can use as border around the gardens. If you have any, we can have please let us now. Enjoy our garden.

We encourage you to get lost enjoying the garden, but not too lost 😊

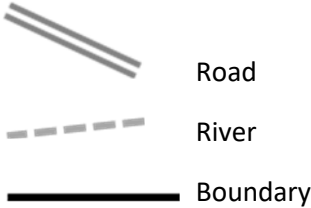

Food, drinks and plants for sale around the pool area

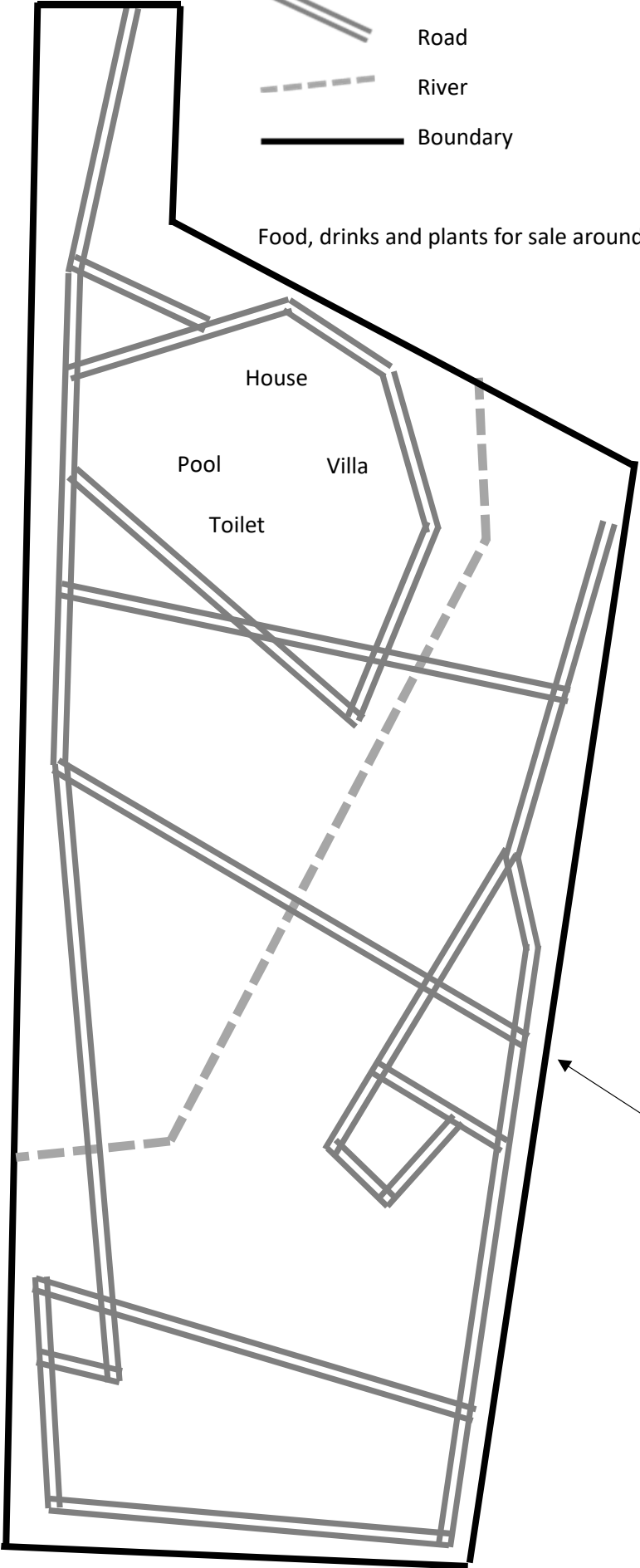

There are also many smaller paths between the roads to explore

Most of the plants below this road were planted in December 2017